

**mall
galleries**
Venue Hire

VENUE HIRE

Art Fairs • Auctions • Exhibitions



OUR STORY



Image: Charlotte Sorapure NEAC, 'Night Still Life'. 61 x 46 cm.

Welcome to Mall Galleries a visual arts charity, managed by the Federation of British Artists.

By hiring Mall Galleries, you are supporting the charitable objectives of the Federation of British Artists to empower artists through a not-for-profit programme of exhibitions and events, prizes and awards with a focus on figurative art.

To understand where it all began, Mall Galleries was officially opened on 25th February 1971 by Her Majesty Queen Elizabeth II. Today, as then, the gallery is home to several royal and national art societies, the oldest of which dates back two hundred years to 1823, and which, combined, represent over 1,000 years of artistic history and heritage.

Located in the cultural heart of London's thriving arts and heritage district on The Mall, between Buckingham Palace and Trafalgar Square, Mall Galleries offers over 450sqm of dedicated exhibition space, spread across three connecting ground level galleries.

Each gallery varies in aesthetic appeal and are well-lit, spacious and equipped to the highest specification. Our spaces are expertly matched with knowledgeable staff and specialist services that have supported a range of National and International exhibitors and artists for over 50 years. As a registered charity with no government funding, we rely on your support to continue to thrive and support artists.

MALL GALLERIES

Over 450sqm of dedicated exhibition space, spread across three connecting ground-level galleries.

Due to the gallery's size, layout, and unique physical features, it is well suited to hosting a wide range of exhibitions as well as art fairs and auctions.

Key features:

- CCTV
- Intruder alarm
- Security gates
- Power
- WiFi
- PA system
- Lift and Ramp Access

[Launch the virtual tour →](#)

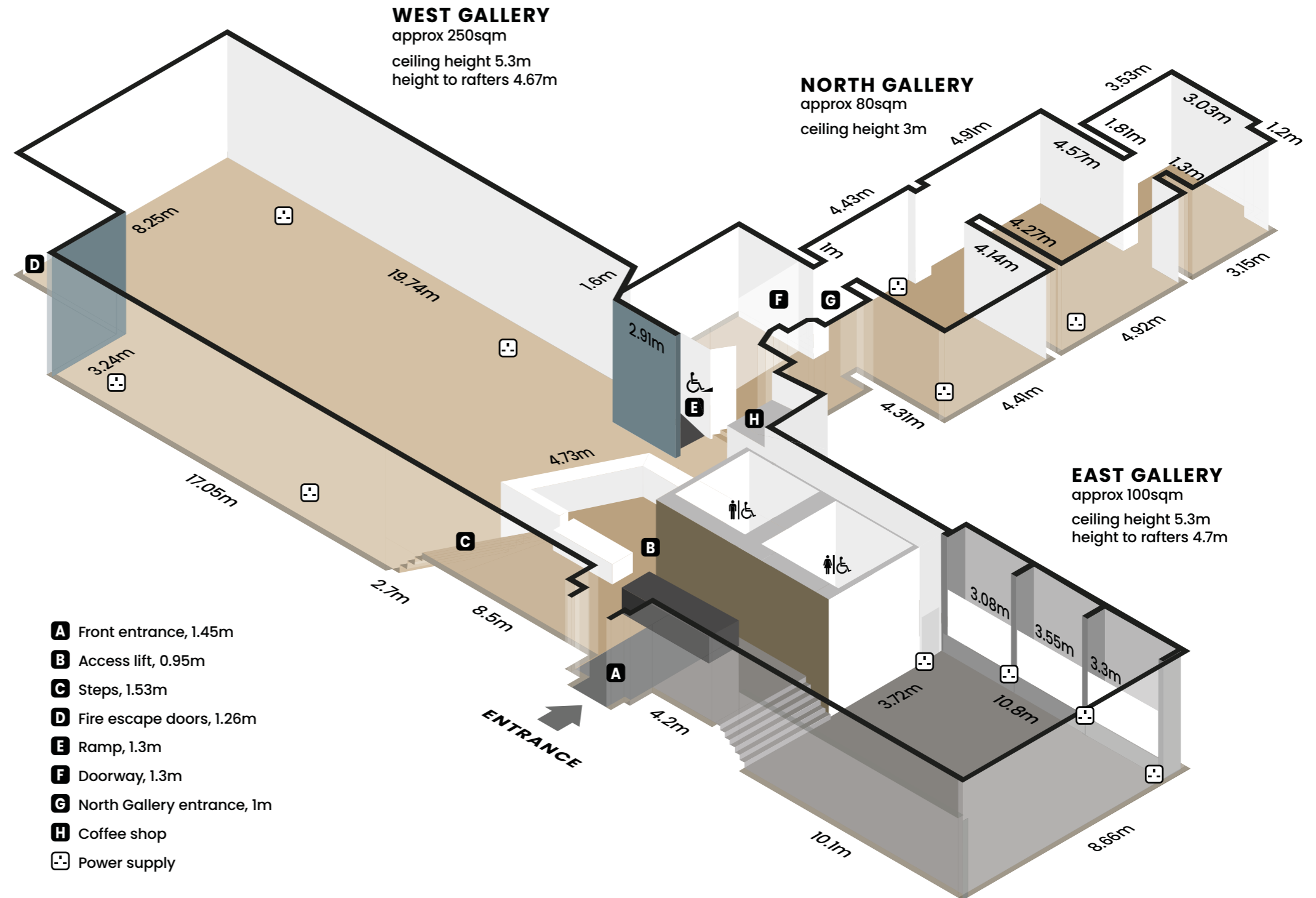

OUR SPACES

WEST, EAST & NORTH GALLERIES

350
Standing
capacity

450sqm
Total floor
area

50k+
Visitors
per year



Mall Galleries

West Gallery

This is the largest exhibiting space with high ceilings and warm oak floors, ideal for a wide range of solo and group shows, art fairs, and auctions.

Facilities

- Oak wood floors
- Museum Standards Accredited
- Gallery grade track lighting
- Climate controlled
- Installation ready walls
- Acoustic panels
- Exhibition partitions
- Dedicated FTTP line

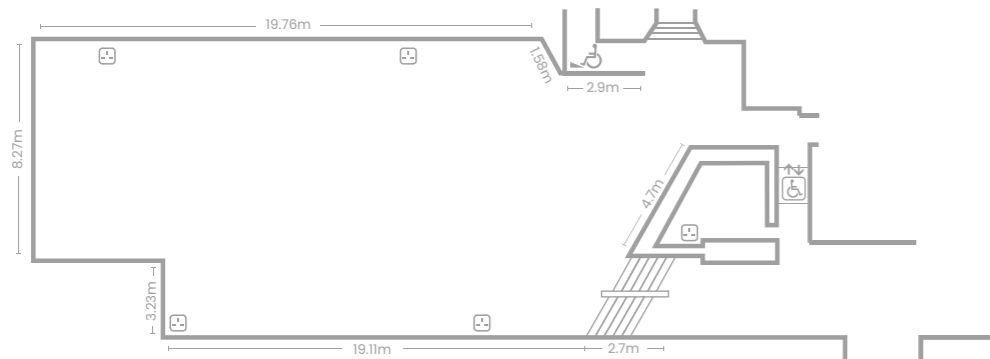

Available floor area 250sqm

[Launch the virtual tour](#)

Mall Galleries

East Gallery

A contemporary, cool gallery space that retains nineteenth-century carriage house features including exposed steel structures, concrete flooring and high-arched windows overlooking The Mall.

Facilities

- Museum Standards Accredited
- Gallery grade track lighting
- Recently renovated floor
- Climate controlled
- Installation ready walls
- Original windows

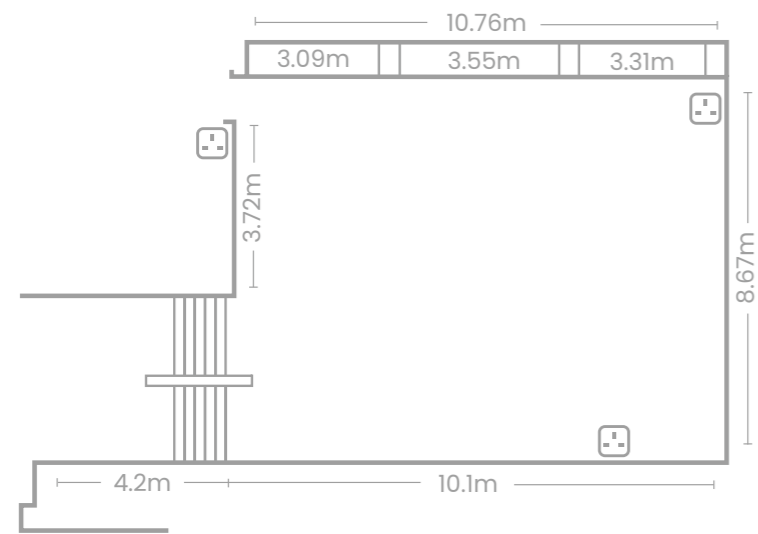

[Launch the virtual tour](#)



Mall Galleries

North Gallery

The space is made up of three interconnecting rooms ideal for intimate private and/or public viewings and can also be used as back of house.

Facilities

- Oak wood floors
- Original arch features
- Track lighting
- Intimate space

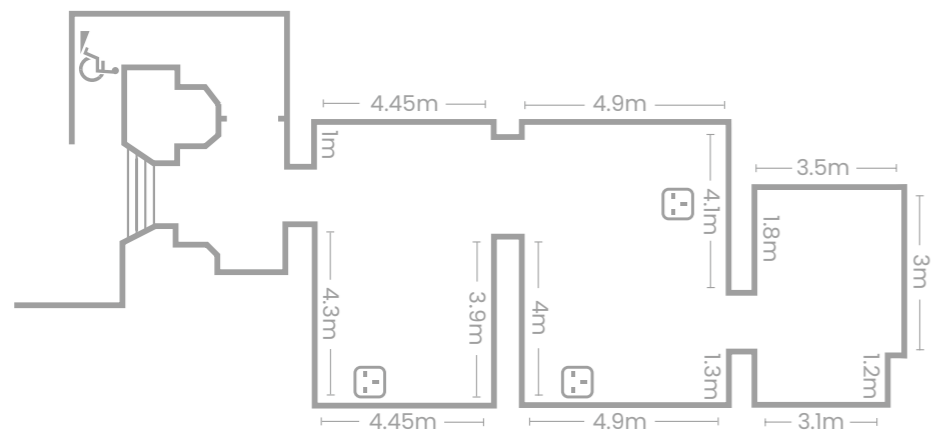

Available floor area 80sqm

[Launch the virtual tour](#)



EXHIBITION SUPPORTED HIRE

£37,000 +VAT

This is designed to support you, the exhibitor, by encompassing all the core elements necessary for a successful exhibiting week. We provide technical support, promotional benefits, and an account manager to offer guidance throughout the preparation process.

Use of West, East and North Galleries for one week.

Art Services

- Technical Project Manager
- Technician support for hang and take-down
- Artwork processing

Promotional Benefits

- Feature in newsletter (35,000 reach)
- A dedicated web page on the Mall Galleries website
- Dedicated posts across digital channels – one pre and two during exhibition (Instagram 59k+, Facebook 35k+, Twitter 16k+)

Reception Night x 1 (Capacity 350)

- Account Manager
- Gallery Reception Staff support
- Duty Manager
- PA and Mic
- Security

Venue Support

- Account Manager
- Duty Manager
- Gallery Assistants





HOW TO APPLY

Mall Galleries welcomes exhibition proposals from solo artists, independent curators, group shows, art societies, as well as art fairs and auctions focusing on a range of artistic disciplines and media.

All exhibitors are required to complete an exhibition proposal form.

Please contact us to discuss availability:

galleryhire@mallgalleries.com

020 7968 0958

T&Cs

1. Exhibition hire is based on a minimum of one week
2. Hire includes installation and dismantle
3. Public opening is typically from Tuesday to Saturday, 10am to 5pm (Changes can be discussed)
4. List of accredited caterers
5. A range of accredited exhibition suppliers are available, from exhibition stands and cabinet hire to production companies and security
6. 10% discount available to registered charities
7. Current pricing is valid until December 2024
8. Prices are subject to VAT at prevailing rate



OUR LOCATION

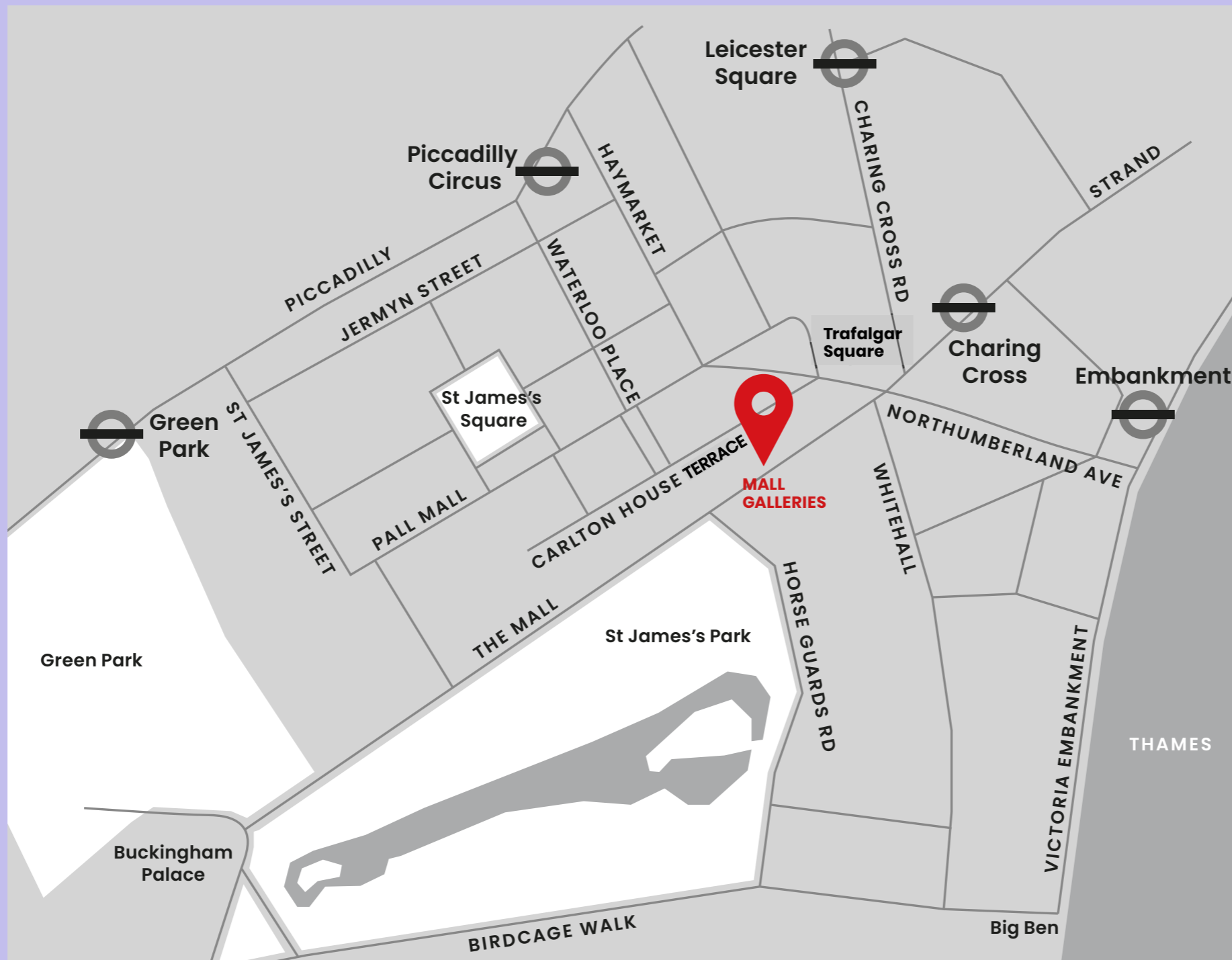

By London Underground

Nearest Stations:

Charing Cross (Northern line, Bakerloo line, 500m, 7 min. walk)

Embankment (Circle, District, Northern, and Bakerloo lines, 650m, 10 min. walk)

Piccadilly Circus (Piccadilly line, Bakerloo line, 800m, 10 min. walk)

By Rail

Nearest Stations:

Charing Cross (500m, 7 min. walk)

Waterloo (0.8 mile, 19 min. walk)

Mall Galleries, The Mall, London SW1

020 7968 0958